



# 80 Charlestown Road, Glossop, Derbyshire, SK13 8LB

**\*\* SEE OUR VIDEO TOUR \*\*** A refurbished stone terrace of character, an ideal first home, with an enclosed, split-level rear garden and offered for sale with No Onward Chain. Less than a mile from Glossop town centre shops and railway station, the property has gas central heating, pvc double glazing and briefly comprises a front lounge with fireplace, a dining kitchen with oven/hob and patio doors, two first floor bedrooms and a bathroom with shower. Energy Rating C

## £189,950

### Viewing arrangements

Viewing strictly by appointment through the agent

44 High Street West, Glossop, Derbyshire, SK13 8BH 01457 858888

### GROUND FLOOR

#### Lounge

12'8 x 12'7 (less stairs)

Pvc front door and pvc double glazed front window, central heating radiator, brick fireplace, gas and electric meter cupboards, two wall light points, spindled stairs leading to the first floor and door through to:

#### Dining Kitchen

12'9 x 8'8

A range of fitted kitchen units including base cupboards and drawers, plumbing for an automatic washing machine, built-in electric oven, work tops over with an inset single drainer stainless steel sink unit and mixer tap, gas hob and filter

hood, matching wall cupboards, fitted shelving, laminate wood flooring, central heating radiator, two pvc double glazed rear windows and patio doors with fitted blinds leading out to the rear garden.

### FIRST FLOOR

#### Landing

#### Bedroom One

12'8 x 9'8 (plus recess)

Pvc double glazed front window, central heating radiator, shelved recess and folding wooden ladder access to the boarded 13'6 x 12'2 roof space with partly restricted head height, Worcester gas fired combination boiler and radiator.

## Bedroom Two

8'9 x 6'7

Pvc double glazed rear window and central heating radiator.

## Bathroom

A white three piece suite including a panelled bath with shower over, pedestal wash hand basin and close coupled wc, chrome finish towel radiator and pvc double glazed rear window.

## OUTSIDE

### Gardens

The property has a split-level rear garden, which includes a patio area and steps down to a lawn.

Our ref :Cms/cms/0916/25

### Agents Notes - HMRC Directive

To be able to sell or purchase a property in the United Kingdom all agents have a legal requirement to conduct Identity checks on all customers involved in the transaction to fulfil their obligations under Anti Money Laundering regulations. We outsource this check to a third party and a charge will apply. Ask the branch for further details.

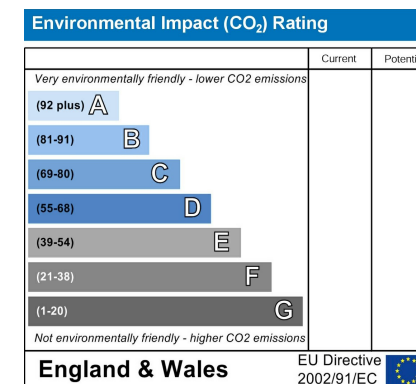
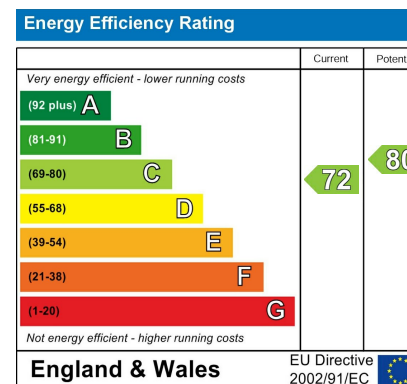



GROUND FLOOR

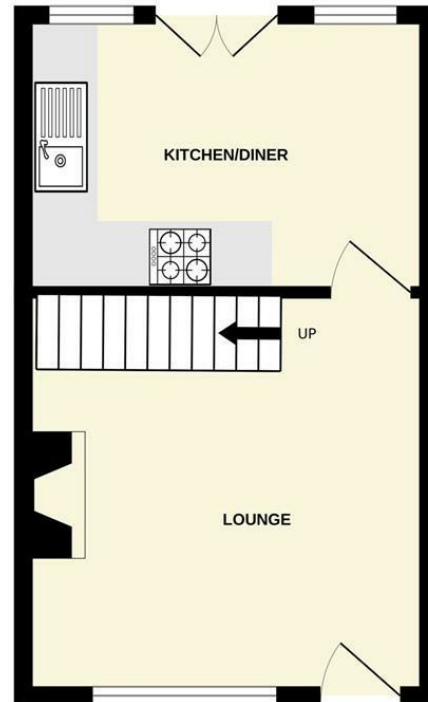

1ST FLOOR

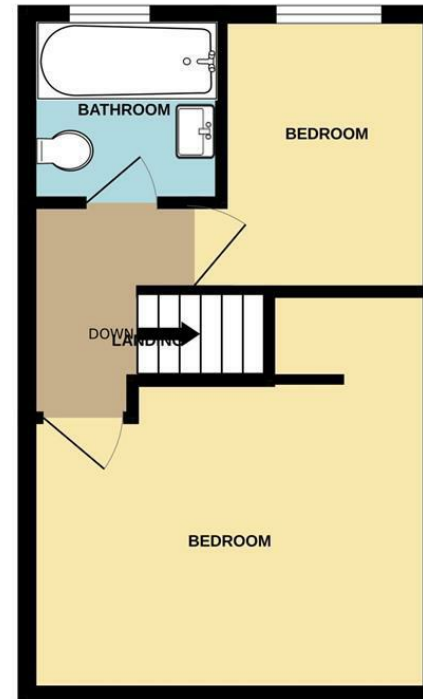

Whilst every attempt has been made to ensure the accuracy of the floorplan contained here, measurements of doors, windows, rooms and any other items are approximate and no responsibility is taken for any error, omission or mis-statement. This plan is for illustrative purposes only and should be used as such by any prospective purchaser. The services, systems and appliances shown have not been tested and no guarantee as to their operability or efficiency can be given.  
Made with Metropix ©2025



These particulars are believed to be accurate but they are not guaranteed and do not form a contract. Neither Jordan Fishwick nor the vendor or lessor accept any responsibility in respect of these particulars, which are not intended to be statements or representations of fact and any intending purchaser or lessee must satisfy himself by inspection or otherwise as to the correctness of each of the statements contained in these particulars. Any floorplans on this brochure are for illustrative purposes only and are not necessarily to scale.

Offices at: Chorlton, Didsbury, Disley, Hale, Glossop, Macclesfield, Manchester Deansgate, Manchester Whitworth Street, New Mills, Sale, Wilmslow and Withington

44 High Street West, Glossop, Derbyshire, SK13 8BH

01457 858888

glossop@jordanfishwick.co.uk  
www.jordanfishwick.co.uk

